

Abmessungen und Gewichte/dimensions and weights (mm,g,kg)

Best.Nr. Orderno.	DN	DIAM	øD	b	h	g/St. g/pc.	St./Rol. pc./rol.	St./Kart. pc./kart.	St./KRV. pc./KRV.	St./lose KRV pc./loose KRV	St./Con.kart. pc./Con.kart.	autom. Verp. autom. pack.		
												St./Rol. pc./rol.	St./Kart. pc./kart.	St./KRV. pc./KRV.
599	25	25 mm	33.0 ± 0.4	4,95 ± 0.3	6,0 ± 0.3	1,8	1.250 pro PE-Beutel	4 Beutel pro Karton	16 Karton pro Palette	80.000				
104	32	32 mm	39.6 ± 0.5	4.9 ± 0.2	6.1 ± 0.2	2.8	40	69.600	69.600	57.600				
580	40	40 mm	51.3 ± 0.5	6.8 ± 0.3	7.8 ± 0.3	5.6	33	37.818	35.640	28.900	36.135			
581	50	50 mm	61.6 ± 0.5	6.8 ± 0.3	7.8 ± 0.3	6.8	34	26.418		21.500	24.990 lose: 30.000	51	26.418	25.704
569	50B	50 mm	61.6 ± 0.5	7.0 ± 0.3	8.4 ± 0.3	7,2	31		23.436			49	26.418	25.382
603	58	58 mm	68.7 ± 0.5	6.9 ± 0.3	9,0 ± 0.3	9,1	43	16.512		16.800				
597		63 mm	74.2 ± 0.6	6.8 ± 0.3	7.8 ± 0.3	8.1	51	18.360		16.800	16.422			
582	70	75 mm	87.1 ± 0.6	6.8 ± 0.3	7.8 ± 0.3	10.2	34	13.260	12.750	15.300	12.750			
596	70B	75 mm	87.1 ± 0.6	7.0 ± 0.3	8.4 ± 0.3	10.1	34	13.260	12.750	13.000	12.750			
578		90 mm	102.8 ± 0.7	7.5 ± 0.3	8.2 ± 0.3	13.4	32	8.736	8.736	14.600	8.064	32	8.736	8.736
579		100 mm	113.8 ± 0.7	7.9 ± 0.3	8.9 ± 0.3	17.3	45	6.480		10.000				
583	100	110 mm	124.1 ± 0.7	7.9 ± 0.3	9.1 ± 0.3	19.9	45	5.220	5.130	6.700	5.307 lose: 10.000		5.220	5.220
595	100B	110 mm	123.8 ± 0.7	8.1 ± 0.3	10.6 ± 0.3	21.5	28	4.872	4.872	5.800	4.524 lose: 10.000	39	4.524	4.524
592		100 SSR	123.8 ± 0.7	7.9 ± 0.3	10.9 ± 0.3	21.5	38	4.788	4.788	7.800				
584	125	125 mm	142.0 ± 0.8	9.6 ± 0.3	10.4 ± 0.3	29.5	25	3.600	3.600	5.480	3.600 lose: 8.000	40	3.600	3.600
575	125B	125 mm	141.8 ± 0.8	9.5 ± 0.3	12.1 ± 0.3	33.3	23	3.312	3.312	4.660				
577	140B	140 mm	163.0 ± 0.8	11.5 ± 0.4	15.5 ± 0.4	57,7	--	400 pro Universalkarton	8 Karton pro Europalette	3.200				
585	150	160 mm	179.6 ± 0.8	10.2 ± 0.3	11.7 ± 0.3	47.4	23	1.932	1.863	3.696	1.932 lose: 4.000	34	1.904	1.836
600	150	160 mm	179.6 ± 0.8	10.5 ± 0.3	11.7 ± 0.3	48.0	23	1.932	1.863	3.696				
576	150B	160 mm	179.6 ± 0.8	11.0 ± 0.3	13.5 ± 0.3	56.0	31	1.736	1.736	2.900			1.736	1.736
586	200	200 mm	224.0 ± 1.0	11.4 ± 0.3	13.0 ± 0.3	73.8	20	1.080	1.080	2.400	1.080	30	1.080	1.080
593		9 Inch	268.5 ± 1.8	13.4 ± 0.4	16.3 ± 0.4	113.0	--	1.320	1.320	3.500				
594	250S	250 mm	273.5 ± 1.8	13.4 ± 0.4	16.3 ± 0.4	123.6	--		1.200	1.500				
587	250	250 mm	282.0 ± 2.0	16.0 ± 0.4	19.5 ± 0.5	181.0	--	1.000	1.000	1.500	1.000			
598	300S	315 mm	344.0 ± 2.0	15.0 ± 0.4	18.5 ± 0.5	197.1	--	660		1.080				
588	300	315 mm	350.1 ± 2.5	17.0 ± 0.4	20.5 ± 0.5	265.3	--	720	720	700	720			
602	350	355 mm	393.7 ± 2.6	18.9 ± 0.5	23.7 ± 0.5	371,3	--	400		600	400			
589	400	400 mm	441.2 ± 3.0	19.0 ± 0.5	24.0 ± 0.5	417,8	--	400	400	500	400			
590	500	500 mm	550.6 ± 3.0	24.6 ± 0.5	30.0 ± 0.5	793.8	--	250	250	250	250			

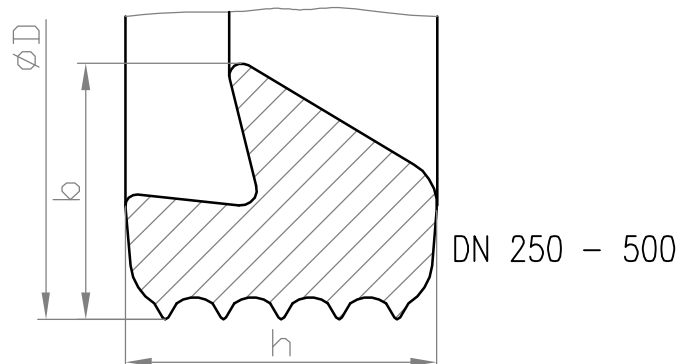
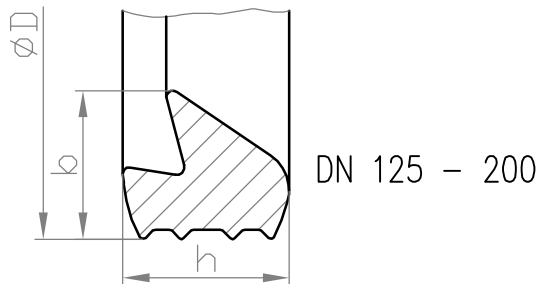
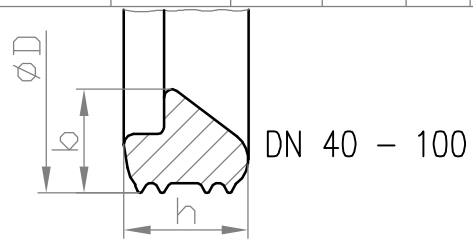
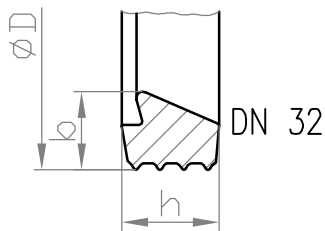

2017 Reinking

Wir behalten uns technische Änderungen vor
We reserve technical modifications



M.O.L. Gummiverarbeitung
GmbH & Co. KG
Gutenbergstr. 12-14
49377 Vechna

Lippendichtring System BL
Lipseal ring system BL
DN 32-500 SBR 60±5 IRHD